

Project: _____

Type: _____ Quantity: _____

The XT represents the latest in LED micro spot design. The XT's light source is the patent pending CR8 LED module. This is the only LED module to easily and quickly interface directly to its host fixture without the need for mounting hardware or orings to secure. Its metal on metal compression heatsink efficiently moves heat away from module through fixture to the cooler surrounding air. Threadless optic holder design makes it quick and easy to change beam spreads night or day. All components are precision CNC machined from solid billet material offering superior strength and fit to cast parts.

Specification

Light Source	C-Socket™ Quick Change™ CR8 LED Module *
LED Rated Life	50,000 hours average **
Input	8 -15Vac
Power Consumption	5 Watts Maximum
Standard LED Color	3000K +/- 175 CCT Typical
CRI	80 Typical
Cable Lead	2 FT 18 AWG
Standard Mounting	Ground Stake
Operating Temperature	-31F to 122F (-35C to 50C)
Maintenance	Tool Free Plug-in LED Module
Thermal Management	Fixture is utilized as heat sink
Ingress Protection	IP66
Certification	

* IES LM-80 Standard ensures led light source will provide lumen maintenance and color performance.

** LED life is defined as the time to 70% lumen maintenance (L70)

Features

- Plug-in CR8 LED Module (Included)
- Renewable LED Module
- Interchangeable Beam Spread (1 Supplied, Specify)
- Compact Size
- Limited internal air space equals greater module cooling
- All components CNC machined from solid billet



Remote Low Voltage Transformer Required
Consult factory for dimming options

Ground Mounting Options (Not to Scale)

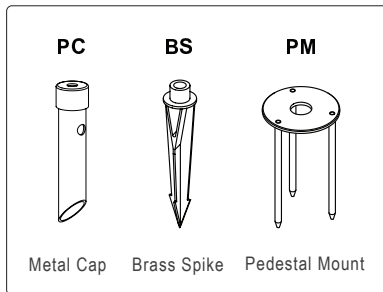

Surface Mounting Options (Not to Scale)

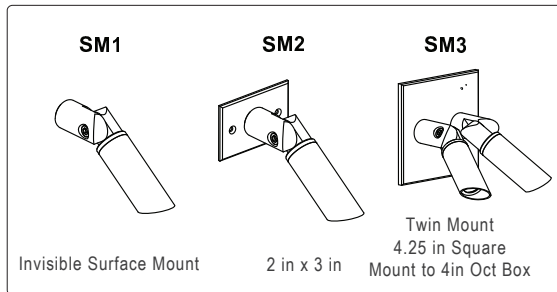

Dimensions inches [mm]

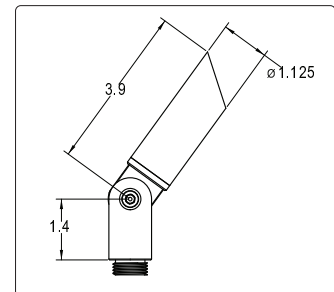

Ordering Guide

Example: **XT-AL-30-M25-HX-MP-SM2** XT, 6061-T6 Alum, 3000K, 25 deg Beam, Hex Cell Louver, Metallic Paint Finish, 2x3 Surface Mount

XT						
-----------	--	--	--	--	--	--

Prefix	Material	LED Color	Beam	Accessory	Finish	Mounting
AL - Alum	BR - Brass	CU - Copper	27 - 2700K 30 - 3000K 40 - 4000K 55 - 5500K	N16 - 16 deg M25 - 25 deg W40 - 40 deg F85 - 85 deg	00 - None HX - Hex Cell	N - Natural BK - Black WT - White BN - Brown GN - Green MP - Metallic NK - Nickel Satin PT - Patina C - Custom
						PV - Ground Stake (Standard) PC - Metal Cap and Post BS - Cast Brass Spike PM - Pedestal Mount SM1 - Surface Invisible SM2 - Surface 2 x 3 SM3 - Surface Twin Mount AR - Adjustable Riser (Specify Separately) TS - Tree Strap (Specify Separately) CS - Custom Design (Consult Factory)



2880 Scott Street, # 107, Vista, CA 92081
 +1 760-734-1123 Tel +1 760-734-1176 Fax
 www.dglights.com info@dglights.com

